

METCALF THREE LIGHT PENDANT

6613203

General Product Information

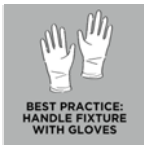
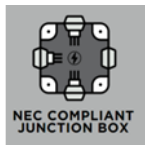
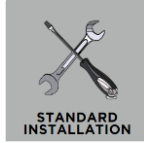

Suggested/Required Tools



Safety Information

CAUTION-RISK OF FIRE

This product must be installed in accordance with the applicable installation code by a person familiar with the construction and operation of the product and the hazards involved.

USE MINIMUM 90°C SUPPLY CONDUCTORS.



Turn off electrical current at the source before working with any lighting fixture or portable lamp.

Install and use this product in adherence with local electrical codes and regulations.

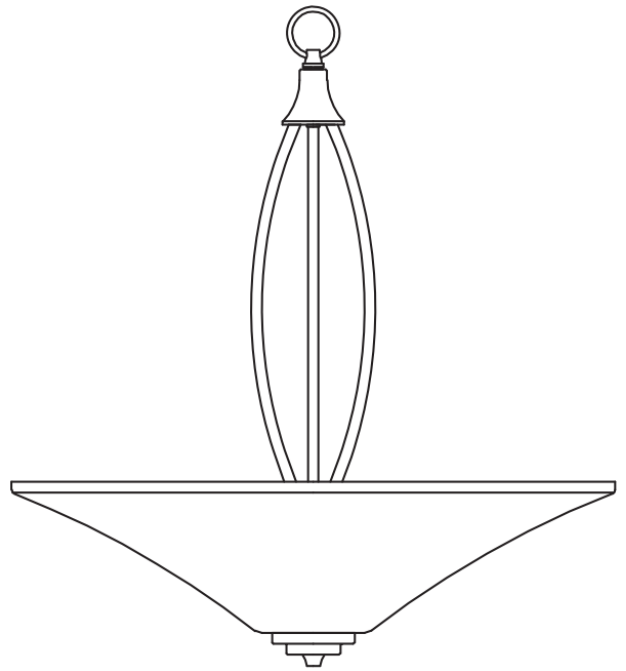

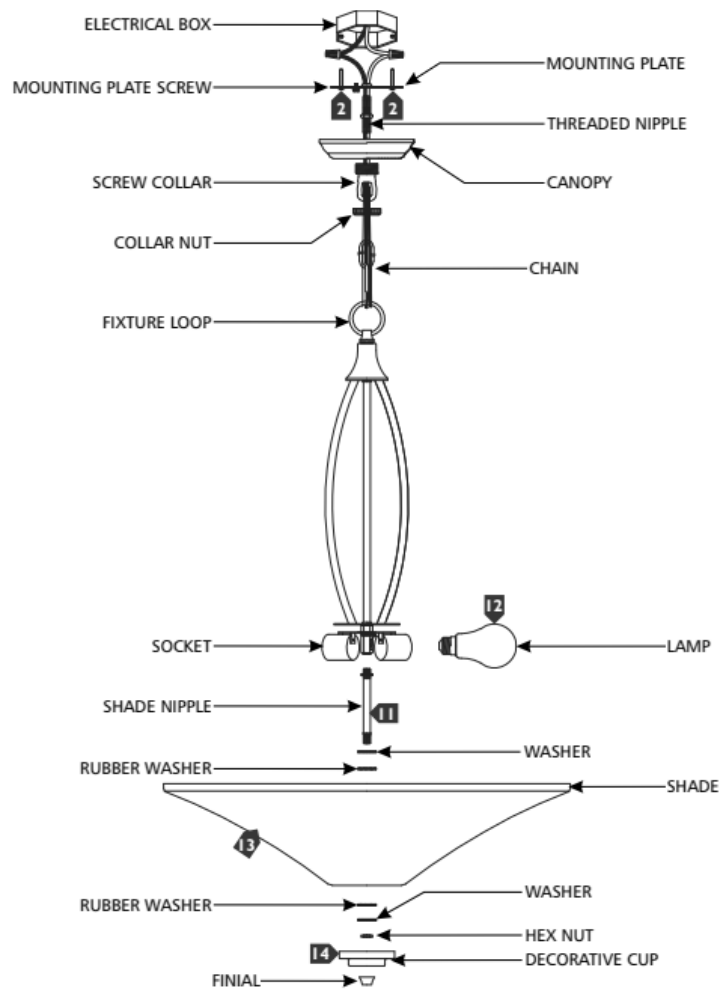

INSTRUCTIONS

I. Preparing the Fixture

1. If necessary, screw the shorter end of the threaded nipple tightly onto the mounting plate.
2. Secure the mounting plate to the electrical box with two mounting plate screws.
3. Temporarily unscrew and remove the collar nut and screw the screw collar tightly onto the threaded nipple.
4. Determine the desired height of the fixture and remove a portion of the chain by opening a link and removing it from the bottom.
5. Install the canopy and collar nut onto the chain in that order, then install the open link onto the fixture loop and secure it in place by closing the link.
6. Weave the cord through the chain, screw collar, canopy, threaded nipple, and out of the electrical box. Trim the cord, leaving enough length to make electrical connections.

II. Wiring the Fixture

1. Safety first! Locate the circuit breaker and switch it off to cut off the power supply to the relevant circuits to ensure there's no electricity running through the wiring.
2. In accordance with local electrical codes, connect the fixture ground wire (bare copper or silver wire) to suitable ground. This may be a green ground screw on the mounting plate, which the ground wire should be tightly wrapped around or a house wire (green or bare copper wire without insulation).
3. Twist the bare ends of the following pairs of wires together using a wire nut to secure a connection:
 - a) Hot fixture wire (black/smooth) to hot power line wire
 - b) Neutral fixture wire (white/textured) to neutral power line wire
4. Carefully tuck all the wires into the junction box.

III. Installing the Fixture

1. Place the canopy onto the ceiling and secure it in place by screwing the collar nut tightly onto the screw collar.
2. Screw the shade nipple to the bottom of the fixture.
3. Screw the lamps into the sockets.
4. Place a washer, rubber washer, the shade, rubber washer, and washer onto the shade nipple in that order, then secure them in place by tightening the hex nut.
5. Place the decorative cup onto the shade nipple and secure it in place by tightening the finial.