

IMPORTANT SAFETY INSTRUCTIONS

CAUTION—Turn off main power at the circuit breaker before installing the fixture, in order to prevent electric shock.

- If you are unclear how to proceed, contact a qualified electrician.
- Read instructions carefully.
- Be sure the electricity to the system you are working on is turned off; either the fuse removed or the circuit breaker set at off.
- Use of other manufacturers components will void warranty, listing and create a potential safety hazard.
- You don't need special tools to install this fixture.
- Be sure to follow the steps in the order given.
- Save these instructions.

NOTE: This unit can be dimmed. We recommend using a Lutron "Skylark" SELVB-300PH_WH or a Leviton 300w "Decora" No 6615-POW.

NOTE: When properly installed to a junction box, there will be a 1/8" gap between the ceiling and the edge of the trim ring. Be sure to keep this air space, it is essential for the proper functioning of the fixture.

NOTE: There are no serviceable parts in this fixture. Do not disassemble.

CLEANING

To clean, wipe fixture with a soft cloth. Clean glass with a mild soap. Do not use abrasive materials such as scouring pads or powders, steel wool or abrasive paper.

ORDERING PARTS

Keep this sheet for future reference, and in case you need to order replacement parts. Parts for this fixture can be ordered from place of purchase. Be sure to use exact wording from illustration when ordering parts.

If different finish trim is desired for your surface mounted fixture, you may order a Sea Gull Lighting #14500s-xxx from any Sea Gull Lighting distributor.

SURFACE MOUNTING INSTALLATION

STEP 1:

Place mounting screws (A) through slots in mounting plate (C). Place support washer (B) on mounting side of plate (A).

STEP 1:

- Use a listed wire nut to connect the fixture hot wire (black wire, or round and smooth tracer) to the supply hot wire.
- Use a listed wire nut to connect the fixture common wire (white wire, or square and rigid) to the supply common wire.
- Gently try to remove the wires from the nut. If you can remove the wires, carefully re-do the wiring connection.

STEP 2:

GROUNDING INSTRUCTIONS:

Connect the supply ground wire, fixture ground wire, and mounting plate ground wire (pre attached) using the supplied wiring connector. Gently try to remove the wires from the connector. If you can remove the wires, carefully re-do the wiring connection.

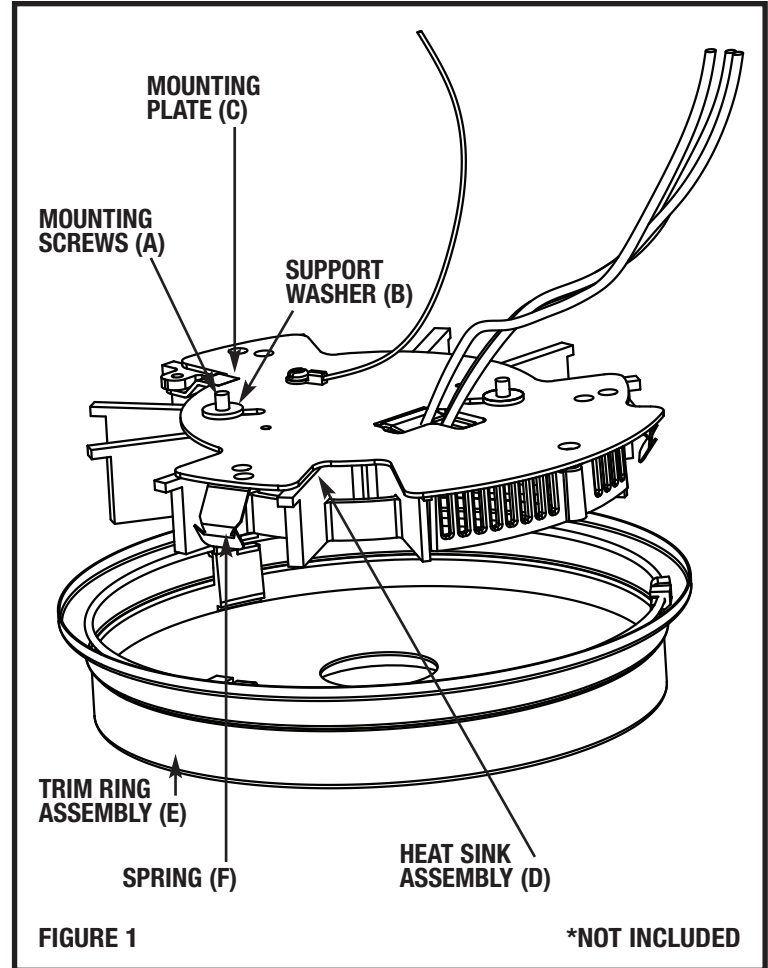

FINAL ASSEMBLY

Make sure no bare wires can be seen outside wire connectors.

STEP 4:

After wires are connected, tuck them carefully inside outlet box and then raise the heat sink assembly (D) against ceiling.

STEP 5:

Secure heat sink assembly (D) to outlet box by tightening mounting screws (A).

STEP 6:

Raise trim ring assembly (E) to heat sink assembly (D). Make sure it properly snaps onto the heat sink assembly (D). If you must remove the trim ring assembly (E), you may do so by gripping the edge of the trim and pulling straight down.

Note: Should a spring (F) overlap the trim ring, do not use excessive force when removing the trim ring assembly (E). Doing so may damage your trim.

STEP 7:

Turn power on.